

SHEEO/NCES Network Data Conference and IPEDS Workshop

April 11-13, 2005

**Crowne Plaza Hotel –
San Antonio Riverwalk**

San Antonio, Texas



2005 SHEEO/NCES Network Conference and IPEDS Workshop

Agenda and Session Descriptions

Sunday, April 10, 2005

5:00 p.m. - 8:00 p.m.

Grand Foyer

Registration Open

6:30 p.m. - 8:00 p.m.

Grand Foyer

Opening Reception – Light Refreshments

Join us for a casual gathering where you can connect with SHEEO and NCES staff and other attendees. A cash bar and light refreshments will be available.

Monday, April 11, 2005

7:30 a.m. - 4:30 p.m.

Grand Foyer

Registration

8:00 a.m. - 8:45 a.m.

Grand Foyer

Continental Breakfast

8:45 a.m. - 9:00 a.m.

Texas Ballroom B & C

Welcome and Introductions

Hans P. L'Orange, Director, SHEEO/NCES Network and Director of Data & Information Management,
State Higher Education Executive Officers

Dennis Carroll, Associate Commissioner, National Center for Education Statistics

Susan G. Broyles, IPEDS Program Director, National Center for Education Statistics

Monday, April 11, 2005

9:00 a.m. - 10:00 a.m.

Texas Ballroom B & C

IPEDS Workshop

This session presents an overview of the IPEDS program by IPEDS and contractor staff, including a review of the recent data collection; plans for the future; a report from the Help Desk; a summary of AIR activities; results of the Technical Review Panel meetings; and an introduction to the new tools available on the IPEDS website.

Lessons Learned from 2004-05

Janice Plotczyk, Team Leader, IPEDS Data Collection, National Center for Education Statistics

Help Desk Report

Janice Kelly-Reid, Senior Survey Director, RTI International
Jamie Isaac, IPEDS Associate Project Director, RTI International

AIR Report

Terrence Russell, Executive Director, Association for Institutional Research
Susan G. Broyles, IPEDS Program Director, National Center for Education Statistics

10:00 a.m. - 10:20 a.m.

Grand Foyer

Break

10:20 a.m. - 12:00 p.m.

Texas Ballroom B & C

IPEDS Workshop (cont.)

Current Projects, New Concepts, and Impact on Future for IPEDS

IPEDS Staff
Mohamad Sakr, Chief Architect, IT Innovative Solutions

12:00 p.m. - 1:00 p.m.

San Antonio Ballroom

Buffet Lunch

1:00 p.m. - 1:30 p.m.

Texas Ballroom B & C

IPEDS Workshop - Wrap Up

Presenter: Susan G. Broyles, IPEDS Program Director, National Center for Education Statistics

This time will be used to answer any questions remaining from the morning session and to set the stage for the remaining IPEDS sessions.

1:30 p.m. - 2:15 p.m.

Texas Ballroom B & C

Data Analysis System (DAS) On-line Demonstration

Presenters:

Samuel Barbett, IPEDS Data Quality Team Leader, National Center for Education Statistics

John Milam, Managing Director, HigherEd.org, Inc.

This session will introduce the newly released IPEDS DAS. We will demonstrate how to specify and generate tables, create Table Parameter Files (TPFs) and import and modify existing TPFs to generate new tables.

2:15 p.m. - 2:30 p.m.

Grand Foyer

Break

2:30 p.m. - 4:30 p.m.

Texas Ballroom B & C

Plenary: IPEDS Unit Record Feasibility Panel

Presentation – General Issues, State Reaction, and Audience Response

Presenters:

Dennis Carroll, Associate Commissioner, National Center for Education Statistics

J. Michael Mullen, Chancellor, West Virginia Higher Education Policy Commission

Panelists:

Julie Carnahan, Director of Research & Information Technology, Chief Information Officer,
Colorado Commission on Higher Education

Toni Larson, Executive Director, Independent Higher Education of Colorado

Kimberly Thompson, Director of Institutional Research, Community College of Denver

NCES recently accepted a study on the feasibility of a Student Unit Record System as part of IPEDS. The study concluded that such a system is feasible but that the final implementation decisions should be left to others. While those decisions are still outstanding, this session will provide some background, perspective, benefits and challenges of collecting unit records in IPEDS. The Associate Commissioner and the West Virginia SHEEO will offer their thoughts followed by the different perspectives (SHEEO staff, community college staff, and independent sector representative) of three data professionals in one state. Substantial time will also be allocated for audience reactions, response, and questions.

4:30 p.m. - 6:00 p.m.

Free Time

6:00 p.m. - 7:30 p.m.

San Antonio Foyer & San Antonio Ballroom

Reception & Speaker: "The Importance of Federal/State Cooperation and Other Reflections from a Departing IPEDS Program Director"

Presenter: Susan G. Broyles, IPEDS Program Director, National Center for Education Statistics

7:30 a.m. - 3:30 p.m.

Grand Foyer

Registration

7:30 a.m. - 8:45 a.m.

Grand Foyer/Texas Ballroom B

Continental Breakfast and Table Topics

Facilitator Detail Can Be Found on Page 13

- Alphabet Soup (Representatives from a Variety of Higher Education Associations—ACE, NACUBO, NAICU, NCHEMS, SREB, and WICHE)
- Candid Conversations with the Associate Commissioner (Tuesday Only)
- Challenges and Approaches to State Higher Education Financial Analysis
- Data Analysis and Management Tools: SQL, SAS, SPSS, and others
- Dual High School and Postsecondary Enrollments
- E-Learning Data Issues
- Emerging Issues in IPEDS - Discussion and Feedback
- First-Professional Degree Classification Project
- IPEDS Data Feedback Report
- Knowledge Resource Strategies—How Do You Turn Data Into Information and Knowledge for Decision Makers?
- NPEC Update: Student Success Initiative
- Q & A Session with IPEDS Staff
- SHEEO/NCES Personnel Exchange Program
- Strategies for Using Your Website as a Communication Tool
- Time to Degree Reporting Challenges

9:00 a.m. - 9:50 a.m.

Concurrent Breakout Sessions

Access and Affordability in Missouri

Texas Ballroom A

Presenters:

Teala Sipes, Research Associate, Missouri Department of Higher Education
John Wittstruck, Director, Educational Policy, Planning, & Improvement Center, Missouri Department of Higher Education

"Access and Affordability: Patterns of Financial Aid and Student Performance for a Cohort of Missouri College Freshmen" examines recent findings from the first phase of this Lumina Foundation for Education-funded project. The MDHE, with technical assistance from the University of Missouri - Columbia Department of Economics, built a longitudinal database of aid and performance data for a Missouri freshman cohort for six Missouri public institutions. Federal, state, and institutional financial aid data; in school employment information; and detailed data on student participation and performance at the participating institutions were also included. The presentation also includes preliminary results from the research the MDHE is doing to assess the performance in public higher education of high school students who take the state's assessment in math and communication arts in the 10th and 11th grades. In addition, we will highlight preliminary results of research into Missouri's state merit-based scholarship recipients' participation in the state's labor force, compared to all graduates of the state's public colleges and universities.

Instructional Costs and Degree Costs—Analysis Strategies from Two States ***Texas Ballroom A***

Presenters:

Nate Johnson, Director, Planning and Institutional Research, State University System of Florida
Jeffrey Phelps, Consultant, Texas Higher Education Coordinating Board

The Board of Governors for the State University System of Florida recently established statewide goals for the numbers of degrees the system would have to award annually by 2012-13 if the state were to achieve a national average ratio of degrees to working age population. With goals established in terms of outputs, the Board is now seeking to understand and manage the system's expenditures in relation to those outputs. The Board retained the services of MGT of America to assist it in analyzing the system's degree costs, differentiating by institution, program and level. The results of the analysis show considerable differences in costs, driven primarily by the cost of instruction (similar to the cost analysis conducted in Texas) and by institutional and discipline-level graduation rates. Just as relevant for other states considering such an analysis, however, are the caveats that accompany the results, the conceptual challenges such an analysis presents, and the alternative methodologies proposed by some of system's member institutions.

For many years, the Texas Higher Education Coordinating Board unsuccessfully tried to determine how much it costs public universities to provide instruction by level and discipline. Previous attempts included an Instruction and Operations matrix intended to represent the statewide average cost of instruction and distribute an average of 60% of total state appropriated funds to the universities. In 2002, the University Formula Advisory Committee began a cost study to validate the relative weights contained in the matrix. This presentation will provide a summary of the results of the study. The Coordinating Board staff also analyzes data to provide an "all funds" analysis of Texas public university costs and revalues the relative weights, which in turn reallocates the Instruction and Operations formula funding among the universities. A majority of the University Formula Advisory Committee and the Coordinating Board believes that it is imperative that the relative weights contained in matrix reflect an objective analysis of universities' actual costs. This approach will significantly improve accountability and transparency related to expenditures at universities.

Intermediate IPEDS PAS

Texas Ballroom C

Presenters:

Janice Plotczyk, Team Leader, IPEDS Data Collection, National Center for Education Statistics
Andrew Mary, Survey Statistician, National Center for Education Statistics

This session is for those who have limited experience using the IPEDS Peer Analysis Tool, for those who are still uncomfortable defining a comparison group, and for those who think that MVL stands for Metro Volleyball League. If you fall into any of those categories, this session is for you. IPEDS staff will show you how to harness the power of the PAS by building a framework of basic design concepts, highlighting system features, and demonstrating examples of actual peer analysis. Problem sheets will be distributed for additional practice at home, and emergency contact numbers will be distributed.

12:00 p.m. - 12:45 p.m.

Texas Ballroom B

Buffet Lunch

12:45 p.m. - 1:30 p.m.

Texas Ballroom B

Luncheon Plenary: A Status Report on the Reauthorization of the Higher Education Act

Speaker: Travis Reindl, Assistant to the President, American Association of State Colleges & Universities

Reauthorization of the Higher Education Act is now well into its third year, and questions abound. When will the process wrap up? Which issues will be hot, and which issues will not? How will this reauthorization set the stage for the next one? Join us for a lively and interactive discussion of the continuing saga.

1:30 p.m. - 1:45 p.m.

Grand Foyer

Break

1:45 p.m. - 2:35 p.m.

Concurrent Breakout Sessions

State FERPA Agreements – Using Data and Protecting Privacy

Texas Ballroom A

Presenters:

Paul Landrum, Data Manager, New Mexico Commission on Higher Education

Jay Pfeiffer, Director, K-20 Education Information and Accountability, Florida Department of Education

A discussion of how states have utilized FERPA to increase access to data resources through responsible data sharing practices using prescribed methods. An overview of datasharing agreements in use to establish guidelines for sharing unit record data between responsible agencies and organizations. Examples of data used to address accountability, outcomes, and effectiveness issues will be discussed.

Advanced IPEDS PAS

Texas Ballroom C

Presenters:

Samuel Barbett, IPEDS Data Quality Team Leader, National Center for Education Statistics

Mohamad Sakr, Chief Architect, IT Innovative Solutions

This session is intended for users who understand the basic concepts behind the Peer Analysis System and who are interested in expanding their use of the PAS. Advanced problem-solving techniques will be covered and examples of complex applications of the PAS will be used to demonstrate additional ways in which the tool can be used. Bring your questions. If you are a moderate to expert user of the PAS, this is the session for you!!

2:45 p.m. - 3:35 p.m.

Concurrent Breakout Sessions

***Occupational Supply Demand System (OSDS)
for Sub-baccalaureate Programs***

Texas Ballroom A

Presenter: Mark Schaff, Ohio IPEDS Coordinator, Labor Economist, Ohio Labor Market Information Bureau

When combined with labor market demand projections of job openings and longitudinal, occupational wage data, the data from the IPEDS completion and graduation rate surveys represent good proxies of supply information for many occupations with which to guide sub-baccalaureate training investments. This combined information about industry and occupational employment projections, wage trends, and training data has now been made universally accessible at a user-friendly, Internet web site called the Occupational Supply/Demand System (OSDS) at <http://www2.gcic.edu/sd/>, which will be demonstrated at the presentation. Recent applications of these supply/demand data will be discussed at the presentation; for instance, please see Inroads: Strategies for Economic Growth, "The Case of Health Care: Regional Strengths", at <http://lmi.state.oh.us/Research/Research.htm>. Think of structured training program completions data as supply information, and come see the interesting investment applications of supply information!

Advanced IPEDS PAS (continued)

Texas Ballroom C

Presenters:

Samuel Barbett, IPEDS Data Quality Team Leader, National Center for Education Statistics
Mohamad Sakr, Chief Architect, IT Innovative Solutions

3:35 p.m.

Adjourn for the Day

5:30 p.m.

Optional Dinner Groups Meet in Lobby

Join your colleagues for a walk to one of several different casual dining options along the Riverwalk.

7:30 a.m. - 12:00 p.m.

Grand Foyer

Registration

7:30 a.m. - 8:40 a.m.

Grand Foyer/Texas Ballroom A & C

Continental Breakfast and Table Topics

Facilitator Detail Can Be Found on Page 14

Table Topics

Texas Ballroom A

- Alphabet Soup (Representatives from a Variety of Higher Education Associations—ACE, NACUBO, NAICU, NCHEMS, SREB, and WICHE)
- Challenges and Approaches to State Higher Education Financial Analysis
- Data Analysis and Management Tools: SQL, SAS, SPSS, and others
- Dual High School and Postsecondary Enrollments
- E-Learning Data Issues
- Emerging Issues in IPEDS - Discussion and Feedback
- First-Professional Degree Classification Project

Table Topics

Texas Ballroom C

- IPEDS Data Feedback Report
- Knowledge Resource Strategies—How Do You Turn Data Into Information and Knowledge for Decision Makers?
- NPEC Update: Student Success Initiative
- Q & A Session with IPEDS Staff
- SHEEO/NCES Personnel Exchange Program
- Strategies for Using Your Website as a Communication Tool
- Time to Degree Reporting Challenges

10:20 a.m. - 11:10 a.m. (continued)

Concurrent Breakout Sessions

Minnesota's College and University Program Planning System (CUPPS)

Texas Ballroom C

Presenter: Craig Schoenecker, System Director for Research, Minnesota State Colleges & Universities System

This session will describe and demonstrate the College and University Program Planning System. CUPPS is an interactive web-based tool designed to provide information that college and university program planners in Minnesota can use to plan new instructional programs and review existing programs. The System provides information that can help to (1) align instructional programs to meet state and regional workforce needs, (2) identify other institutions' programs and their market share and (3) view prior graduates' outcomes to assess past performance. Chief Academic Officers, Academic Deans, Faculty, System and state-level staff can use information from CUPPS for (a) program planning and approval; (b) program review; (c) program accountability; and (d) regional and institutional planning. CUPPS integrates six higher education data sets (program offerings, IPEDS completions, IPEDS institutional characteristics, graduate related employment rates, graduate wage rates and full-year equivalent enrollment) and five labor market data sets (employment, job vacancies, projected openings, unemployment insurance claims and wage rates by occupation).

11:15 a.m. - 12:00 p.m.

Texas Ballroom B

Wrap Up – A Chance to Address or Revisit Anything Left Outstanding

Presenters:

Susan G. Broyles, IPEDS Program Director, National Center for Education Statistics

Hans P. L'Orange, Director, SHEEO/NCES Network and Director of Data & Information Management,
State Higher Education Executive Officers

One final Conference/Workshop opportunity to discuss IPEDS and whatever else is on your mind. Bring your outstanding questions and issues to this interactive wrap-up session with IPEDS staff and be prepared to participate. Are there still questions on the table? Issues that didn't get addressed fully? Concerns about future directions? Things you've meant to ask Susan Broyles over the years? This is your chance.

12:00 p.m.

Adjourn

Table Topics & Volunteer Facilitators

Tuesday, April 12, 2005

7:30 a.m. - 8:45 a.m.

Texas Ballroom B

Thank you to all of this year's facilitators.

(Not all facilitators will be available both days)

Alphabet Soup: Representatives from a Variety of Higher Education Associations Sharing Current Activity

Cheryl Blanco, Western Interstate Commission for Higher Education (WICHE)
Melanie Corrigan, American Council on Education (ACE)
Patrick Kelly, National Center for Higher Education Management Systems (NCHEMS)
Joseph Marks, Southern Regional Education Board (SREB)
Elise Miller, National Association of Independent Colleges & Universities (NAICU)
Brian Prescott, Western Interstate Commission for Higher Education (WICHE)
Jessica Shedd, National Association of College and University Business Officers (NACUBO)

Candid Conversations with the Associate Commissioner (Tuesday Only)

Dennis Carroll, National Center for Education Statistics

Challenges and Approaches to State Higher Education Financial Analysis

Cathy Statham, National Center for Education Statistics
David Wright, State Higher Education Executive Officers

Data Analysis and Management Tools: SQL, SAS, SPSS, and others

Debbie Brennan, Utah System of Higher Education
Charlene Coles, Florida Department of Education
Patricia DeWitt, Georgia Foundation for Independent Colleges, Inc.

Dual High School and Postsecondary Enrollments

Sandra Kinney, Georgia Department of Technical and Adult Education
Dawn Ressel, Kansas Board of Regents
Kimberly Thompson, Community College of Denver

E-Learning Data Issues

Joseph Marks, Southern Regional Education Board

Emerging Issues in IPEDS - Discussion and Feedback

Janice Plotczyk, National Center for Education Statistics

First-Professional Degree Classification Project

Edward Delaney, NCES Senior Fellow

IPEDS Data Feedback Report

Susan Broyles, National Center for Education Statistics

Knowledge Resource Strategies—How Do You Turn Data Into Information and Knowledge for Decision Makers?

Camille Brown, South Carolina Commission on Higher Education
Robert Burke, Association of Independent Colleges & Universities of Ohio
Nancy Szofran, Idaho State Board of Education

NPEC Update: Student Success Initiative

James Hearn, Vanderbilt University
William Proctor, Florida Council for Education Policy Research & Improvement

Q & A Session with IPEDS Staff

Patricia Brown, National Center for Education Statistics
Andrew Mary, National Center for Education Statistics
Sabrina Ratchford, National Center for Education Statistics

SHEEO/NCES Personnel Exchange Program

Hans L'Orange, State Higher Education Executive Officers

Strategies for Using Your Website as a Communication Tool

Kathryn Dodge, New Hampshire Postsecondary Education Commission
Barbara McCuen, Nebraska Coordinating Commission for Postsecondary Education

Time to Degree Reporting Challenges

Kenneth Dalley, Texas Higher Education Coordinating Board
Nate Johnson, State University System of Florida
John Wittstruck, Missouri Department of Higher Education

Table Topics & Volunteer Facilitators

Wednesday, April 13, 2005

7:30 a.m. - 8:40 a.m.

Texas Ballroom A

Alphabet Soup: Representatives from a Variety of Higher Education Associations Sharing Current Activity

Cheryl Blanco, Western Interstate Commission for Higher Education (WICHE)
Melanie Corrigan, American Council on Education (ACE)
Patrick Kelly, National Center for Higher Education Management Systems (NCHEMS)
Joseph Marks, Southern Regional Education Board (SREB)
Elise Miller, National Association of Independent Colleges & Universities (NAICU)
Brian Prescott, Western Interstate Commission for Higher Education (WICHE)
Jessica Shedd, National Association of College and University Business Officers (NACUBO)

Challenges and Approaches to State Higher Education Financial Analysis

Cathy Statham, National Center for Education Statistics
David Wright, State Higher Education Executive Officers

Data Analysis and Management Tools: SQL, SAS, SPSS, and others

Debbie Brennan, Utah System of Higher Education
Charlene Coles, Florida Department of Education
Patricia DeWitt, Georgia Foundation for Independent Colleges, Inc.

Dual High School and Postsecondary Enrollments

Sandra Kinney, Georgia Department of Technical and Adult Education
Dawn Ressel, Kansas Board of Regents
Kimberly Thompson, Community College of Denver

E-Learning Data Issues

Joseph Marks, Southern Regional Education Board

Emerging Issues in IPEDS - Discussion and Feedback

Janice Plotczyk, National Center for Education Statistics

First-Professional Degree Classification Project

Edward Delaney, NCES Senior Fellow

Texas Ballroom C

IPEDS Data Feedback Report

Susan Broyles, National Center for Education Statistics

Knowledge Resource Strategies—How Do You Turn Data Into Information and Knowledge for Decision Makers?

Camille Brown, South Carolina Commission on Higher Education
Robert Burke, Association of Independent Colleges & Universities of Ohio
Nancy Szofran, Idaho State Board of Education

NPEC Update: Student Success Initiative

James Hearn, Vanderbilt University
William Proctor, Florida Council for Education Policy Research & Improvement

Q & A Session with IPEDS Staff

Patricia Brown, National Center for Education Statistics
Andrew Mary, National Center for Education Statistics
Sabrina Ratchford, National Center for Education Statistics

SHEEO/NCES Personnel Exchange Program

Hans L'Orange, State Higher Education Executive Officers

Strategies for Using Your Website as a Communication Tool

Kathryn Dodge, New Hampshire Postsecondary Education Commission
Barbara McCuen, Nebraska Coordinating Commission for Postsecondary Education

Time to Degree Reporting Challenges

Kenneth Dalley, Texas Higher Education Coordinating Board
Nate Johnson, State University System of Florida
John Wittstruck, Missouri Department of Higher Education

Sessions-At-A-Glance

Sunday, April 10, 2005

	Grand Foyer	Texas Ballroom A	Texas Ballroom B	Texas Ballroom C		
7:30 a.m.						
8:00 a.m.	<div style="border: 2px solid black; padding: 10px;"> <p>The registration and information desk will be open in the Grand Foyer:</p> <p>Sunday: 5:00 - 8:00 p.m. Monday: 7:30 a.m. - 4:30 p.m. Tuesday: 7:30 a.m. - 3:30 p.m. Wednesday: 7:30 a.m. - 12:00 p.m.</p> </div>					
8:30 a.m.						
9:00 a.m.						
9:30 a.m.						
10:00 a.m.						
10:30 a.m.						
11:00 a.m.						
11:30 a.m.						
12:00 p.m.						
12:30 p.m.						
1:00 p.m.						
1:30 p.m.						
2:00 p.m.						
2:30 p.m.						
3:00 p.m.						
3:30 p.m.						
4:00 p.m.						
4:30 p.m.						
5:00 p.m.						
5:30 p.m.						
6:00 p.m.						
6:30 p.m.						
7:00 p.m.	<div style="border: 1px solid black; padding: 5px;"> <p>Opening Reception 6:30-8:00 p.m.</p> </div>					
7:30 p.m.						

Monday, April 11, 2005

	Grand Foyer	Texas Ballroom A	Texas Ballroom B	Texas Ballroom C
7:30 a.m.				
8:00 a.m.	Continental Breakfast 8:00 - 8:45 a.m.			
8:30 a.m.				
9:00 a.m.			Welcome and Introductions 8:45 - 9:00 a.m.	
9:30 a.m.			IPEDS Workshop 9:00 - 10:00 a.m.	
10:00 a.m.	Break 10:00 - 10:20 a.m.			
10:30 a.m.				
11:00 a.m.			IPEDS Workshop 10:20 a.m. - 12:00 p.m.	
11:30 a.m.				
12:00 p.m.	Buffet Lunch in the <u>San Antonio Ballroom</u> 12:00 - 1:00 p.m.			
12:30 p.m.				
1:00 p.m.			IPEDS Workshop 1:00 - 1:30 p.m.	
1:30 p.m.			DAS Demonstration 1:30 - 2:15 p.m.	
2:00 p.m.				
2:30 p.m.	Break 2:15 - 2:30 p.m.			
3:00 p.m.			Plenary: IPEDS Unit Record Feasibility Panel 2:30 - 4:30 p.m.	
3:30 p.m.				
4:00 p.m.				
4:30 p.m.				
5:00 p.m.				
5:30 p.m.				
6:00 p.m.	Reception and Speaker in the <u>San Antonio Ballroom</u> 6:00 - 7:30 p.m.			
6:30 p.m.				
7:00 p.m.				
7:30 p.m.				

Sessions-At-A-Glance

Tuesday, April 12, 2005

	Grand Foyer	Texas Ballroom A	Texas Ballroom B	Texas Ballroom C	
7:30 a.m.	Continental Breakfast 7:30 - 8:45 a.m.		Table Topics 7:30 - 8:45 a.m.		
8:00 a.m.					
8:30 a.m.					
9:00 a.m.		Access and Affordability in Missouri 9:00 - 9:50 a.m.		VA Data Warehouse & Student Tracking Svcs. 9:00 - 9:50 a.m.	
9:30 a.m.					
10:00 a.m.		As America Becomes More Diverse 10:00 - 10:50 a.m.		Elementary IPEDS Tools 10:00 - 10:50 a.m.	
10:30 a.m.					
11:00 a.m.		Instructional Costs and Degree Costs 11:00 - 11:50 a.m.		Intermediate IPEDS PAS 11:00 - 11:50 a.m.	
11:30 a.m.					
12:00 p.m.	Break 1:30 - 1:45 p.m.		Buffet Lunch 12:00 - 12:45 p.m.		
12:30 p.m.			Luncheon Plenary: HEA Reauthorization 12:45 - 1:30 p.m.		
1:00 p.m.					
1:30 p.m.					
2:00 p.m.		State FERPA Agreements 1:45 - 2:35 p.m.		Advanced IPEDS PAS 1:45 - 2:35 p.m.	
2:30 p.m.					
3:00 p.m.		Occupational Supply Demand System 2:45 - 3:35 p.m.		Advanced IPEDS PAS (cont.) 2:45 - 3:35 p.m.	
3:30 p.m.					
4:00 p.m.					
4:30 p.m.					
5:00 p.m.					
5:30 p.m.		Optional Dinner Groups Meet in Lobby 5:30 p.m.			
6:00 p.m.					
6:30 p.m.					
7:00 p.m.					
7:30 p.m.					

Wednesday, April 13, 2005

	Grand Foyer	Texas Ballroom A	Texas Ballroom B	Texas Ballroom C
7:30 a.m.	Continental Breakfast 7:30 - 8:40 a.m.	Table Topics 7:30 - 8:40 a.m.		Table Topics 7:30 - 8:40 a.m.
8:00 a.m.				
8:30 a.m.				
9:00 a.m.			Plenary Panel – Accountability Policy Strategies in the States 8:45 - 10:00 a.m.	
9:30 a.m.				
10:00 a.m.				
10:00 a.m.	Break 10:00 - 10:20 a.m.	Data for Accountability in the States 10:20 - 11:10 a.m.		Minnesota's Program Planning System 10:20 - 11:10 a.m.
10:30 a.m.				
11:00 a.m.				
11:30 a.m.			Wrap up 11:15 a.m. - 12:00 p.m.	
12:00 p.m.				
12:30 p.m.				
1:00 p.m.				
1:30 p.m.				
2:00 p.m.				
2:30 p.m.				
3:00 p.m.				
3:30 p.m.				
4:00 p.m.				
4:30 p.m.				
5:00 p.m.				
5:30 p.m.				
6:00 p.m.				
6:30 p.m.				
7:00 p.m.				
7:30 p.m.				

Alphabetical List of Participants

Patrick Alles
Director of Research & Information
Technology
Independent Colleges of Indiana
101 West Ohio Street, Suite 440
Indianapolis, IN 46204
(317) 236-6085 Fax: (317) 236-6086
patrick@icindiana.org

Dan Anderson
Assistant Executive Director for
Institutional Analysis
Arizona Board of Regents
2020 North Central Avenue, Suite 230
Phoenix, AZ 85004-4593
(602) 229-2544 Fax: (602) 229-2555
Dan.Anderson@asu.edu

Samuel Barbett
IPEDS Data Quality Team Leader
National Center for Education Statistics
1990 K Street, NW, Room 8113C
Washington, DC 20006
(202) 502-7305 Fax: (202) 502-7460
samuel.barbett@ed.gov

Jim Barton
Director of Research & Technology
West Virginia Higher Education
Policy Commission
1018 Kanawha Boulevard, East Suite 700
Charleston, WV 25301
(304) 558-1112 Fax: (304) 558-5719
barton@hepc.wvnet.edu

Charles N. Benil
Director, Office of Information Systems
Maryland Higher Education Commission
839 Bestgate Road, Suite 400
Annapolis, MD 21401
(410) 260-4524 Fax: (410) 260-3203
cbenil@mhec.state.md.us

Kathy Benson
Assistant Director, Educational Data
Analysis Support Center
Texas Higher Education Coordinating
Board
P.O. Box 12788
Austin, TX 78711
(512) 427-6286 Fax: (512) 427-6447
kathy.benson@thehb.state.tx.us

Tara Bisel
Data Analyst
State Higher Education Executive Officers
700 Broadway, Suite 1200
Denver, CO 80203-3460
(303) 299-3682 Fax: (303) 296-9016
tbisel@sheeo.org

Cheryl D. Blanco
Senior Program Director, Policy Analysis
& Research
Western Interstate Commission for
Higher Education
P.O. Box 9752
Boulder, CO 80301-9752
(303) 541-0221 Fax: (303) 541-0291
cblanco@wiche.edu

Violet A. Boyer
President & CEO
Association of Independent Colleges
of Washington
600 Stewart Street, Suite 600
Seattle, WA 98101-1230
(206) 623-4494 Fax: (206) 625-9621
violet@ICWashington.org

Debbie Brennan
Director of Warehousing/Databases
Utah System of Higher Education
Board of Regents Building, The Gateway
60 South 400 West
Salt Lake City, UT 84101-1284
(801) 321-7154 Fax: (801) 321-7199
dbrennan@utahsbr.edu

Chris Brewer
Director of Student Information Systems
Tennessee Higher Education Commission
404 James Robertson Parkway
Parkway Towers, Suite 1900
Nashville, TN 37243
(615) 741-7566 Fax: (615) 741-6230
chris.brewer@state.tn.us

Constance S. Brizuela
Director, Office of Institutional Analysis
University of Wyoming
1000 East University Avenue
Dept. #3314, Old Main 414
Laramie, WY 82071-3314
(307) 766-2898 Fax: (307) 766-3289
hanuman@uwyo.edu

Camille T. Brown
M.I.S. Manager
South Carolina Commission on
Higher Education
1333 Main Street, Suite 200
Columbia, SC 29201
(803) 737-2149 Fax: (803) 737-2297
cbrown@che.sc.gov

J. Keith Brown
Associate Vice President for Planning,
Accountability, Research & Evaluation
North Carolina Community College System
200 West Jones Street
Raleigh, NC 28603
(919) 807-6979 Fax: (919) 807-7168
brownk@ncccs.cc.nc.us

Patricia Q. Brown
Survey Director
National Center for Education Statistics
1990 K Street, NW, Room 8133
Washington, DC 20006
(202) 502-7317 Fax: (202) 502-7450
patricia.brown@ed.gov

Susan Brown
Deputy Assistant Commissioner for
Planning & Accountability
Texas Higher Education Coordinating
Board
P.O. Box 12788
Austin, TX 78711
(512) 427-6153 Fax: (512) 427-6127
susan.brown@thehb.state.tx.us

Susan G. Broyles
IPEDS Program Director
National Center for Education Statistics
1990 K Street, NW, Room 8113A
Washington, DC 20006
(202) 502-7318 Fax: (202) 502-7460
susan.broyles@ed.gov

Andrea Bryant
Policy Analyst
Wyoming Community College Commission
2020 Carey Avenue, 8th Floor
Cheyenne, WY 82002
(307) 777-7226 Fax: (307) 777-6567
abryant@commission.wcc.edu

Robert P. Burke
Director of Research
Association of Independent Colleges &
Universities of Ohio
17 South High Street, Suite 1020
Columbus, OH 43215-3473
(614) 228-2196 Fax: (614) 228-8406
rburke@aicuo.edu

Susan Campbell
Policy Research Associate
Board of Regents of the University System
of Georgia
270 Washington Street, SW
Atlanta, GA 30334
(404) 657-8883 Fax: (404) 657-4130
susan.campbell@usg.edu

Julie Carnahan
Director of Research & Information
Technology, Chief Information Officer
Colorado Commission on Higher Education
1380 Lawrence Street, Suite 1200
Denver, CO 80204-2059
(303) 866-2723 Fax: (303) 866-4266
Julie.Carnahan@state.co.us

Alphabetical List of Participants

Dennis Carroll
Associate Commissioner
National Center for Education Statistics
1990 K Street, NW, Room 8112
Washington, DC 20006
(202) 502-7323 Fax: (202) 502-7460
dennis.carroll@ed.gov

Patricia Casagrande
Assistant Director of Institutional Research
University & Community College System
of Nevada
2601 Enterprise Road
Reno, NV 89512
(775) 784-4901 Fax: (775) 784-1127
patc@nevada.edu

John G. Clark
Data Analyst
National Center for Higher Education
Management Systems
P.O. Box 9752
Boulder, CO 80301-9752
(303) 497-0308 Fax: (303) 497-0338
john@nchems.org

Charlene Coles
Systems Program Administrator
Florida Department of Education
Information Resource Mgmt-Universities
325 W. Gaines Street
Tallahassee, FL 32399-0400
(850) 245-9593 Fax: (850) 245-0419
charlene.coles@fldoe.org

Elmer E. Colon-Rivera
Chief Information Officer
Puerto Rico Council on Higher Education
P.O. Box 19900
San Juan, PR 00910-1900
(787) 724-7100 Fax: (787) 725-6447
el_colon@ces.gobierno.pr

Melanie E. Corrigan
Associate Director, Center for
Policy Analysis
American Council on Education
One Dupont Circle NW, Suite 800
Washington, DC 20036
(202) 939-9554
melanie_corrigan@ace.nche.edu

Fred A. Curran
Director, Institutional Studies
University of Vermont
440 College Street
Burlington, VT 05405-0162
(802) 656-1167 Fax: (802) 656-2046
fred.curran@uvm.edu

Kenneth Dalley
Director Education Data Center
Texas Higher Education Coordinating
Board
P.O. Box 12788
Austin, TX 78711-2788
(512) 427-6306 Fax: (512) 427-6447
kenneth.dalley@theccb.state.tx.us

Gloria Davila-Casasnovas
Director of Policy & Planning
Puerto Rico Council on Higher Education
P.O. Box 19900
San Juan, PR 00910-1900
(787) 724-7100 Fax: (787) 721-6447
gl_davila@ces.gobierno.pr

Susan Degen
Financial Aid Analyst
Oregon Student Assistance Commission
1500 Valley River Drive, Suite 100
Eugene, OR 97401-2185
(541) 687-7451 Fax: (541) 687-7414
susan.r.degen@state.or.us

Edward L. Delaney
Senior Fellow, NCES/AIR
Association for Institutional Research
1615 Sherwood Hall Lane
Alexandria, VA 22306
(703) 768-6190 Fax: (703) 768-5242
edelaney@intercom.net

Patricia DeWitt
Research Director
Georgia Foundation for Independent
Colleges, Inc.
Shorter College
315 Shorter Avenue
Rome, GA 30165
(404) 233-7308 Fax: (404) 233-7458
patdewitt@shorter.edu

Alexandra Djurovich
Research Associate
Minnesota Higher Education
Services Office
1450 Energy Park Drive, Suite 300
St. Paul, MN 55108-5227
(651) 642-0586 Fax: (651) 642-0675
djurovich@heso.state.mn.us

Kathryn G. Dodge
Executive Director
New Hampshire Postsecondary Education
Commission
3 Barrell Court, Suite 300
Concord, NH 03275
(603) 271-2555 Fax: (603) 271-2696
kdodge@pec.state.nh.us

David W. Gardner
Associate Commissioner, Academic
Excellence and Research
Texas Higher Education Coordinating
Board
P.O. Box 12788
Austin, TX 78711-2788
(512) 427-6146 Fax: (512) 427-6127
david.gardner@theccb.state.tx.us

Beverlin Givens
Distance Education Specialist
Mississippi State Board for Community
& Junior Colleges
3825 Ridgewood Road
Jackson, MS 39211
(601) 432-6518 Fax: (601) 432-6363
bgivens@sbcjc.cc.ms.us

Diana Gonzalez
Policy and Operations Analyst
Board of Regents, State of Iowa
11260 Aurora Avenue
Urbandale, IA 50322-7905
(515) 281-6116 Fax: (515) 281-6420
gonzalez@iastate.edu

Matthew Greene
IPEDS Help Desk
RTI International
P.O. Box 3040
Research Triangle Park, NC 27709
(919) 541-6490 Fax: (919) 316-3866
mgreene@rti.org

Keith Greiner
Research Director
Iowa College Student Aid Commission
200 Tenth Street, 4th Floor
Des Moines, IA 50309-3609
(515) 242-3390 Fax: (515) 242-3388
keith.greiner@iowa.gov

Kurt Gunnell
Associate Director of Institutional Research
Kansas Board of Regents
1000 SW Jackson Street, Suite 520
Topeka, KS 66612-1368
(785) 368-7360 Fax: (785) 296-0983
kgunnell@ksbor.org

Theresa R. Hay
Assistant Commissioner for Planning
& Research
Louisiana Board of Regents
P.O. Box 3677
Baton Rouge, LA 70821-3677
(225) 342-4253 Fax: (225) 342-9318
thay@regents.state.la.us

Alphabetical List of Participants

James C. Hearn
Professor of Public Policy and
Higher Education
Vanderbilt University
Department of Leadership, Policy
& Organizations
Peabody #514
Nashville, TN 37203-5721
(615) 322-8041 Fax: (615) 343-7094
j.hearn@vanderbilt.edu

Billy Helton
Assistant Director of Information
Reporting Services
University of North Carolina
Office of the President
910 Raleigh Road, P.O. Box 2688
Chapel Hill, NC 27515-2688
(919) 962-4552 Fax: (919) 962-4316
heltonbl@northcarolina.edu

Paula R. Hollis
Research Coordinator
University System of New Hampshire
25 Concord Road
Durham, NH 03824
(603) 862-0965 Fax: (603) 862-0909
paula.hollis@unh.edu

Harold Horton
Director of Higher Education Information
Services
Ohio Board of Regents
30 East Broad Street, 35th Floor
Columbus, OH 43215
(614) 644-5796 Fax: (614) 728-0102
hhorton@regents.state.oh.us

Cathie M. Hudson
Associate Vice Chancellor, Strategic
Research & Analysis
Board of Regents of the University System
of Georgia
270 Washington Street, SW
Atlanta, GA 30334
(404) 656-2213 Fax: (404) 657-4130
cathie.mayes.hudson@usg.edu

Myrna Huffman
Director, Information Systems
California Community Colleges
1102 Q Street
Sacramento, CA 95814
(916) 327-2246 Fax: (916) 327-5889
mhuffman@ccccc.edu

Jamie Isaac
IPEDS Associate Project Director
RTI International
P.O. Box 3040
Research Triangle Park, NC 27709
(919) 541-6342 Fax: (919) 541-1261
isaac@rti.org

Sally Jackson
Research Assistant
University & Community College System
of Nevada
2601 Enterprise Road
Reno, NV 89512
(775) 784-4901 Fax: (775) 784-1127
sallyj@nevada.edu

Nate Johnson
Director, Planning and Institutional
Research
State University System of Florida
325 West Gaines Street
Tallahassee, FL 32399-0400
(850) 245-9719 Fax: (850) 245-9685
Nathaniel.Johnson@fldoe.org

Linda K. Keep
Director of Computing
National Center for Higher Education
Management Systems
P.O. Box 9752
Boulder, CO 80301-9752
(303) 497-0314 Fax: (303) 497-0338
linda@nchems.org

Jonathan Keller
Associate Vice Chancellor for Planning
& Research
Massachusetts Board of Higher Education
One Ashburton Place, Room 1401
Boston, MA 02108
(617) 994-6941 Fax: (617) 727-0955
jkeller@bhe.mass.edu

Michael J. Keller
Director of Policy Analysis & Research
Maryland Higher Education Commission
839 Bestgate Road, Suite 400
Annapolis, MD 21401-3013
(410) 260-4559 Fax: (410) 260-3201
mkeller@mhec.state.md.us

Patrick J. Kelly
Senior Associate
National Center for Higher Education
Management Systems
P.O. Box 9752
Boulder, CO 80301-9752
(303) 497-0307 Fax: (303) 497-0338
patrick@nchems.org

Janice Ennis Kelly-Reid
Senior Survey Director
RTI International
3040 Cornwallis Road
P.O. Box 12194
Research Triangle Park, NC 27709
(919) 541-6020 Fax: (919) 316-3866
jrk@rti.org

Barbara T. Kern
Supervisor, Statistical Services Unit
Pennsylvania Department of Education
Division of Data Services
333 Market Street
Harrisburg, PA 17126-0333
(717) 783-6764 Fax: (717) 787-3148
bkern@state.pa.us

Sandra Kinney
Coordinator for Information Services
Georgia Department of Technical &
Adult Education
1800 Century Place, NE, Suite 590
Atlanta, GA 30345
(678) 491-9709
skinney@dtae.org

Jeff Kinsey
Enterprise Reporting Administrator
Pennsylvania State System of
Higher Education
2300 Vartan Way
Harrisburg, PA 17110
(717) 703-5415 Fax: (717) 703-5444
jkinsey@sytecpa.org

Kimberly Kirkpatrick
Assistant Commissioner for Information
Services & Institutional Research
Louisiana Board of Regents
1201 North Third Street, Suite 6-200
Baton Rouge, LA 70802
(225) 342-4253 Fax: (225) 342-9318
kkirkpatrick@regents.state.la.us

Judith A. Knapp
Coordinator, Student Financial
Assistance/Research & Studies
New Hampshire Postsecondary Education
Commission
3 Barrell Court, Suite 300
Concord, NH 03301-8543
(603) 271-2555 Fax: (603) 271-2696
jknapp@pec.state.nh.us

Sathasivam Krishnan
Director of Research
New Jersey Commission on Higher
Education
20 West State Street
P.O. Box 542
Trenton, NJ 08625-0542
(609) 984-2684 Fax: (609) 292-7225
kkrishnan@che.state.nj.us

Paul W. Landrum
Data Manager
New Mexico Commission on Higher
Education
1068 Cerrillos Road
Santa Fe, NM 87505
(505) 476-6526 Fax: (505) 476-6511
plandrum@che.state.nm.us

Alphabetical List of Participants

Toni E. Larson
Executive Director
Independent Higher Education of Colorado
518 Seventeenth Street, Suite 387
Denver, CO 80202
(303) 571-5559 Fax: (303) 571-5231
toni.larson@mindspring.com

Barbara Lauren
Associate Director, Research
American Association of Collegiate
Registrars & Admissions Officers
One Dupont Circle, NW, Suite 520
Washington, DC 20036-1135
(202) 293-9161 Fax: (202) 872-8857
laurenb@aacrao.org

Paul E. Lingenfelter
Executive Director
State Higher Education Executive Officers
700 Broadway, Suite 1200
Denver, CO 80203-3460
(303) 299-3627 Fax: (303) 296-9016
plingenfelter@sheeo.org

Hans P. L'Orange
Director, SHEEO/NCES Network & Director
of Data & Information Management
State Higher Education Executive Officers
700 Broadway, Suite 1200
Denver, CO 80203-3460
(303) 299-3688 Fax: (303) 296-9016
hlorange@sheeo.org

Pamela M. Lowrey
Assistant Director for Policy Studies
Illinois Community College Board
401 East Capitol Avenue
Springfield, IL 62701
(217) 782-9574 Fax: (217) 524-4981
plowrey@iccb.state.il.us

Tao Lu
Specialist, Management Information
Services
California Community Colleges
Chancellor's Office
1102 Q Street
Sacramento, CA 95814
(916) 322-2802 Fax: (916) 327-5889
tlu@cccco.edu

George Malo
Associate Vice Chancellor for Research
& Assessment
Tennessee Board of Regents
1415 Murfreesboro Road, Suite 350
Nashville, TN 37215
(615) 366-4444 Fax: (615) 366-3996
gmalo@tbr.state.tn.us

Joseph L. Marks
Director of Education Data Services
Southern Regional Education Board
592 Tenth Street NW
Atlanta, GA 30318
(404) 875-9211 Fax: (404) 872-1477
joe.marks@sreb.org

Julie Martfeld
Staff Programmer Analyst
California Postsecondary Education
Commission
1303 J Street, Suite 500
Sacramento, CA 95814
(916) 332-8030 Fax: (916) 327-4417
jmartfeld@cpec.ca.gov

Andrew Mary
Survey Statistician
National Center for Education Statistics
1990 K Street, NW, Room 8131
Washington, DC 20006
(202) 502-7337 Fax: (202) 502-7450
andrew.mary@ed.gov

Tod R. Massa
Director, Policy Research & Data
Warehousing
State Council of Higher Education
for Virginia
101 North 14th Street, 10th Floor
James Monroe Building
Richmond, VA 23219
(804) 225-3147 Fax: (804) 371-2870
todmassa@schev.edu

Mitzi Matts
Web Specialist
Idaho State Board of Education
650 West State Street
Boise, ID 83720
(208) 334-1585 Fax: (208) 334-2632
mmatts@osbe.state.id.us

Mari W. McCarty
Senior Vice President
Wisconsin Association of Independent
Colleges & Universities
122 West Washington Avenue, #700
Madison, WI 53703-2783
(608) 256-7761 Fax: (608) 256-7065
mari.mccarty@waicuweb.org

Barbara McCuen
Research Coordinator
Nebraska Coordinating Commission for
Postsecondary Education
140 North 8th Street, Suite 300
P.O. Box 95005
Lincoln, NE 68509-5005
(402) 471-0031 Fax: (402) 471-2886
barbara.mccuen@ccpe.ne.gov

Lynn W. Metcalf
Interim Director for Finance, Facilities,
& MIS
South Carolina Commission on Higher
Education
1333 Main Street, Suite 200
Columbia, SC 29201
(803) 737-2265 Fax: (803) 737-2297
lmetcalf@che.sc.gov

Sue Ellen Michalek
Senior Institutional Planner
University of Wisconsin System
1220 Linden Drive
1538 Van Hise Hall
Madison, WI 53706
(608) 262-1751 Fax: (608) 265-3175
smichalek@uwsa.edu

John H. Milam
Managing Director
HigherEd.org, Inc.
21 S. Kent Street
Winchester, VA 22601
(540) 722-6060 Fax: (540) 722-4225
jmilam@highered.org

Elise Miller
Assistant Director of Research &
Policy Analysis
National Association of Independent
Colleges & Universities
1025 Connecticut Avenue, NW, Suite 700
Washington, DC 20012
(202) 785-8866 Fax: (202) 835-0002
elise@naicu.edu

Claire Sams Milligan
Internal Auditor/IPEDS Coordinator
Alabama Department of Postsecondary
Education
P.O. Box 302130
401 Adams Avenue, 2nd Floor
Montgomery, AL 36130
(334) 242-2897 Fax: (334) 353-5437
milligan@acs.cc.al.us

Patty Mosqueda
Policy Associate
Washington Higher Education
Coordinating Board
917 Lakeridge Way
P.O. Box 43430
Olympia, WA 98504-3430
(360) 753-7863 Fax: (360) 753-7808
pattym@hecb.wa.gov

Alphabetical List of Participants

J. Michael Mullen
Chancellor
West Virginia Higher Education Policy
Commission
1018 Kanawha Boulevard, East Suite 700
Charleston, WV 25301
(304) 558-0699 Fax: (304) 558-1011
mullen@hepc.wvnet.edu

Sharyn Nakamoto
Director, Institutional Research Office
University of Hawaii System
1633 Bachman Pl, SA-1, Room 4
Honolulu, HI 96822
(808) 956-7532 Fax: (808) 956-9870
sharynn@hawaii.edu

Laurie Neils
System Data & Research Officer
Montana University System
2500 Broadway
P.O. Box 203101
Helena, MT 59620-3101
(406) 444-0323 Fax: (406) 444-1469
lneils@oche.montana.edu

Thomas M. North
Institutional Research Systems Analyst
Oregon University System
P.O. Box 3175
Eugene, OR 97403-0175
(541) 346-5713 Fax: (541) 346-5790
tom_north@ous.edu

Sherri Noxel
Director, Information & Research
Kentucky Council on Postsecondary
Education
1024 Capital Center Drive, Suite 320
Frankfort, KY 40601-8204
(502) 573-1555 Fax: (502) 573-1535
sherri.noxel@ky.gov

Gina Padilla
Academic Affairs Assistant
North Dakota University System
600 East Boulevard Avenue, Dept. 215
Bismarck, ND 58505-0230
(701) 328-2964 Fax: (701) 328-2961
gina.padilla@ndus.nodak.edu

Ginger Pauley
Institutional Reporting Manager
University of Phoenix
4615 East Elwood Street
Mail Stop AA F101
Phoenix, AZ 85040-1958
(480) 557-1142 Fax: (480) 829-3756
ginger.pauley@phoenix.edu

George Pernsteiner
Acting Chancellor
Oregon University System
PO Box 3175
Eugene, OR 97403
(541) 346-5794 Fax: (541) 346-5764
george_ernsteiner@ous.edu

Dianne K. Peterson
Assistant to the Director, SHEEO/NCES
Network
State Higher Education Executive Officers
700 Broadway, Suite 1200
Denver, CO 80203-3460
(303) 299-3687 Fax: (303) 296-9016
dpeterson@sheeo.org

Jay Pfeiffer
Assistant Deputy Commissioner for
Accountability Research & Measurement
Florida Department of Education
844 Turlington Building
325 West Gaines Street
Tallahassee, FL 32399-0400
(850) 245-9114 Fax: (850) 245-9106
jay.pfeiffer@fldoe.org

Jeffrey Phelps
Consultant
14525 Ridgetop Terrace
Austin, TX 78732
(512) 266-7576
jphelps@tsus.edu

Alan Phillips
Data Analyst
Delaware Higher Education Commission
820 North French Street
Carvel State Office Building
Wilmington, DE 19802
(302) 577-5240 Fax: (302) 577-6765
aphillips@doe.k12.de.us

Janice Plotczyk
Team Leader, IPEDS Data Collection
National Center for Education Statistics
1990 K Street, NW, Room 8022
Washington, DC 20006
(202) 502-7459 Fax: (202) 502-7460
janice.plotczyk@ed.gov

John D. Porter
Associate Provost for Institutional
Research
State University of New York
System Administration
SUNY Plaza, S523
353 Broadway
Albany, NY 12246
(518) 443-5646 Fax: (518) 443-5632
john.porter@suny.edu

John Pothier
Associate Director, Research
Connecticut Department of Higher
Education
61 Woodland Street
Hartford, CT 06105-2326
(860) 947-1837 Fax: (860) 947-1311
jpothier@ctdhe.org

Brian Prescott
Research Associate, Policy Analysis
& Research
Western Interstate Commission for
Higher Education
P.O. Box 9752
Boulder, CO 80301-9752
(303) 541-0255 Fax: (303) 541-0291
bprescott@wiche.edu

William B. Proctor
Executive Director
Council for Education Policy Research
& Improvement
111 West Madison Street
Suite 574 Pepper Building
Tallahassee, FL 32399-1400
(850) 488-7894 Fax: (850) 922-5388
Proctor.Bill@leg.state.fl.us

Christian Pruet
Senior Research & Statistical Analyst
Mississippi Institutions of Higher Learning
3825 Ridgewood Road
Jackson, MS 39211-6453
(601) 432-6445 Fax: (601) 432-6117
cpruett@ihl.state.ms.us

James Purcell
Executive Director of State System
Research
Oklahoma State Regents for
Higher Education
655 Research Parkway, Suite 200
Oklahoma City, OK 73104
(405) 225-9176 Fax: (405) 225-9230
jpurcell@osrhe.edu

Sabrina Ratchford
Statistician
National Center for Education Statistics
1990 K Street, NW, Room 8116
Washington, DC 20006
(202) 502-7436 Fax: (202) 502-7450
sabrina.ratchford@ed.gov

Jeannie Reed
Research Analyst & Data Coordinator
West Virginia Higher Education Policy
Commission
1018 Kanawha Boulevard, East Suite 700
Charleston, WV 25301
(304) 558-1112 Fax: (304) 558-4820
reedjr@hepc.wvnet.edu

Alphabetical List of Participants

Travis Reindl
Assistant to the President; Director, State
Policy Analysis
American Association of State Colleges
& Universities
1307 New York Avenue, NW, 5th floor
Washington, DC 20005-4701
(202) 478-4657 Fax: (202) 478-5491
reindlt@aascu.org

Robyn R. Render
Vice President for Information Resources
& Chief Information Officer
University of North Carolina
Office of the President
910 Raleigh Road, P.O. Box 2688
Chapel Hill, NC 27515-2688
(919) 962-4908 Fax: (919) 962-4734
rrr@northcarolina.edu

Dawn Ressel
Director of Institutional Research
Kansas Board of Regents
1000 SW Jackson Street, Suite 520
Topeka, KS 66612-1368
(785) 368-7464 Fax: (785) 296-0983
dressel@ksbor.org

Yuhang Rong
Associate Director for Academic Affairs
Connecticut Department of Higher
Education
61 Woodland Street
Hartford, CT 06105-2326
(860) 947-1822 Fax: (860) 947-1310
yrong@ctdhe.org

Terrence Russell
Executive Director
Association for Institutional Research
Florida State University
114 Stone Building
Tallahassee, FL 32308
(850) 644-4470 Fax: (850) 644-8824
trussell@mailers.fsu.edu

Mohamad Sakr
Chief Architect
IT Innovative Solutions
19640 Clubhouse Road
Montgomery Village, MD 20886
(240) 361-1334 Fax: (240) 361-1340
mohamad@inovas.net

Mark J. Schaff
Ohio IPEDS Coordinator
Ohio Labor Market Information Bureau
Ohio Department of Job & Family Services
4300 Kimberly Parkway, 3rd Floor
Columbus, OH 43232
(614) 466-1109 Fax: (614) 752-9621
schafm01@odjfs.state.oh.us

Julie Schepp
Academic Affairs Associate & Director
of Research
North Dakota University System
600 East Boulevard Avenue, Dept. 215
10th Floor, State Capitol
Bismarck, ND 58501
(701) 328-4136 Fax: (701) 328-2961
julie.schepp@ndus.nodak.edu

Robert E. Schmidt
Director of Institutional Research
& Effectiveness
Norwich University
158 Harmon Drive
Northfield, VT 05060
(802) 485-2088 Fax: (802) 485-2727
schmidt@norwich.edu

Craig Schoenecker
System Director for Research
Minnesota State Colleges & Universities
System
Suite 500 Wells Fargo Place
30 East 7th Street
St. Paul, MN 55101
(651) 296-9600 Fax: (651) 297-1814
craig.schoenecker@so.mnscu.edu

Nancy K. Scott
LMI Analyst/IPEDS Lead Worker
Ohio Department of Job & Family Services
Labor Market Information Bureau
4927 Kristie Falls
Columbus, OH 43221
(614) 752-6686 Fax: (614) 752-9621
scottn01@odjfs.state.oh.us

Michael D. Scroggins
Director for Information & Technology
Washington State Board for Community
& Technical Colleges
319 SE 7th Avenue
P.O. Box 42495
Olympia, WA 98504-2495
(360) 704-4377 Fax: (360) 586-6440
msscroggins@sbctc.ctc.edu

Jennifer Seabaugh
Manager of Information and Research
Indiana Commission for Higher Education
101 West Ohio Street, Suite 550
Indianapolis, IN 46204-1971
(317) 464-4400 Fax: (317) 464-4410
jennifers@che.state.in.us

Douglas Shapiro
Vice President for Research &
Policy Development
Minnesota Private College Council
445 Minnesota Street, Suite 500
St. Paul, MN 55101
(651) 293-6804 Fax: (651) 228-0379
dshapiro@mnprivatecolleges.org

Jessica Shedd
Director of Research and Policy Analysis
National Association of College &
University Business Officers
2501 M Street, NW, Suite 400
Washington, DC 20037
(202) 861-2527 Fax: (202) 449-1230
jessica.shedd@nacubo.org

Diane Sherman
Director of Institutional Research
Alabama Commission on Higher Education
100 North Union Street, Suite 768
P.O. Box 302000
Montgomery, AL 36130-2000
(334) 242-2742 Fax: (334) 242-0268
dsherman@ache.state.al.us

Judy Shishido
Analyst, Institutional Research
University of Hawaii System
1633 Bachman Place, SA-2, Room 4
Honolulu, HI 96822
(808) 956-7532 Fax: (808) 956-9870
jas@hawaii.edu

Donna Silber
Coordinator, Institutional Effectiveness
Maricopa Community College District
2411 West 14th Street
Tempe, AZ 85281-6941
(480) 731-8689 Fax: (480) 731-8788
donna.silber@domail.maricopa.edu

Teala Sipes
Research Associate
Missouri Department of Higher Education
3515 Amazonas Drive
Jefferson City, MO 65109-5717
(573) 751-8746 Fax: (573) 751-6635
teala.sipes@dhe.mo.gov

Peter Small
Institutional Research Analyst
University of Maine System
107 Maine Avenue
Bangor, ME 04401
(207) 973-3210 Fax: (207) 973-3296
small@maine.edu

Andre Smith
Director, Florida Education & Training
Placement Information Program
Florida Department of Education
325 West Gaines Street
844 Turlington Building
Tallahassee, FL 32399-0400
(850) 245-0429- Fax: (850) 245-9106
andre.smith@fldoe.org

Alphabetical List of Participants

Cathy Statham
IPEDS Survey Director, Finance
& Enrollment
National Center for Education Statistics
1990 K Street, NW, Room 8130
Washington, DC 20006
(202) 502-1383 Fax: (202) 502-7450
Cathy.Statham@ed.gov

Robert Strickland
Manager, Application and Data Services
South Carolina Technical College System
111 Executive Center Drive
Columbia, SC 29210
(803) 896-5398 Fax: (803) 896-5329
strickland@sctechsystem.com

Hope Swanson
Director of Institutional Research
Vermont State Colleges
P.O. Box 359
Waterbury, VT 5676-0359
(802) 241-3574 Fax: (802) 241-3369
hope.swanson@castleton.edu

Nancy Szofran
Chief Technology Officer
Idaho State Board of Education
650 West State
P.O. Box 83720
Boise, ID 83720-0037
(208) 332-1572 Fax: (208) 332-1584
nszofran@osbe.state.id.us

Farah Thompson
Programmer/Analyst
Utah System of Higher Education
Board of Regents Building, The Gateway
60 South 400 West
Salt Lake City, UT 84101-1284
(801) 321-7161 Fax: (801) 321-7199
fthompson@utahsbr.edu

Judith Thompson
Research & Accountability Analyst
Florida Community College System
325 West Gaines Street, Suite 1324
Tallahassee, FL 32399
(850) 245-9506 Fax: (850) 245-9499
judith.thompson@fldoe.org

Kimberly A. Thompson
Director of Institutional Research
Community College of Denver
9101 East Lowry Boulevard
Campus Box 285, P.O. 173363
Denver, CO 80217-3363
(303) 556-6178 Fax: (303) 352-3030
Kimberly.Thompson@ccd.edu

Isabelle Tissier
Research Analyst
University of Alaska System
910 Yukon Drive
Fairbanks, AK 99775
(907) 474-5336 Fax: (907) 474-6682
snigt@email.alaska.edu

Melinda Tobin
Interim Assistant Director of System
Research
Pennsylvania State System of
Higher Education
2986 North 2nd Street
Harrisburg, PA 17110
(717) 720-4222 Fax: (717) 720-7222
mtobin@passhe.edu

Janelle Toman
Director of Information & Institutional
Research
South Dakota Board of Regents
306 East Capitol Avenue, Suite 200
Pierre, SD 57501-2545
(605) 773-3455 Fax: (605) 773-2422
janellet@ris.sdbor.edu

Sharon K. Tucker
Data Analyst
Arkansas Department of Higher Education
114 East Capitol Avenue
Little Rock, AR 72201
(501) 371-2069 Fax: (501) 371-2002
sharont@adhe.arknet.edu

Kevin Turner
Student Warehouse Database
Administrator
Montana University System
2500 Broadway, P.O. Box 203101
Helena, MT 59620-3101
(406) 265-4174 Fax: (406) 444-1469
kturner@oche.montana.edu

Laura Tyree
Assistant Director, State System Research
Oklahoma State Regents for
Higher Education
655 Research Parkway, Suite 200
Oklahoma City, OK 73104
(405) 225-9164 Fax: (405) 225-9230
ltyree@osrhe.edu

Margaret Watrous
Program Research Specialist
New York State Education Department
89 Washington Avenue, EBA 964
Albany, NY 12234
(518) 486-5257 Fax: (518) 474-1907
mwatrous@mail.nysed.gov

Timothy Weis
Survey/Database Technician
Nebraska Coordinating Commission for
Postsecondary Education
P.O. Box 95005
Lincoln, NE 68509-5005
(402) 471-8276 Fax: (402) 471-2886
tim.weis@ccpe.ne.gov

Christina Whitfield
Director, Research & Policy Analysis
Kentucky Community & Technical
College System
300 North Main Street
Versailles, KY 40383
(859) 256-3184 Fax: (859) 256-3126
christina.whitfield@kctcs.edu

Susan B. Winter
Webmaster/Policy Analyst
State Higher Education Executive Officers
700 Broadway, Suite 1200
Denver, CO 80203-3460
(303) 229-3676 Fax: (303) 296-9016
swinter@sheeo.org

John R. Wittstruck
Director, Educational Policy, Planning, &
Improvement Center
Missouri Department of Higher Education
3515 Amazonas Drive
Jefferson City, MO 65109-5717
(573) 751-2361 Fax: (573) 751-6635
john.wittstruck@dhe.mo.gov

David Wright
Senior Research Analyst
State Higher Education Executive Officers
700 Broadway, Suite 1200
Denver, CO 80203-3460
(303) 299-3677 Fax: (303) 296-9016
dwright@sheeo.org

Carol K. Yoakum
Assistant Director
Illinois Board of Higher Education
431 East Adams Street, 2nd Floor
Springfield, IL 62701-1418
(217) 557-7342 Fax: (217) 782-8548
yoakum@ibhe.org

List of Participants by State

STATE	ORGANIZATION	NAME
Alabama	Commission on Higher Education	Diane Sherman
	Department of Postsecondary Education	Claire Sams Milligan
Alaska	University of Alaska	Isabelle Tissier
Arizona	Board of Regents	Dan Anderson
	Maricopa Community College District	Donna Silber
	University of Phoenix	Ginger Pauley
Arkansas	Department of Higher Education	Sharon K. Tucker
California	Community Colleges	Myrna Huffman
		Tao Lu
	Postsecondary Education Commission	Julie Martfeld
Colorado	Commission on Higher Education	Julie Carnahan
	Community College of Denver	Kimberly A. Thompson
	Independent Higher Education of Colorado	Toni E. Larson
Connecticut	Department of Higher Education	John Pothier Yuhong Rong
Delaware	Higher Education Commission	Alan Phillips
Florida	Community College System	Judith Thompson
	Council for Education Policy Research & Improvement	William Proctor
	Department of Education	Charlene Coles
		Jay J. Pfeiffer
	State University System of Florida	Andre Smith Nate Johnson
Georgia	Board of Regents of the University System of Georgia	Susan Campbell
		Cathie Mayes Hudson
	Department of Technical & Adult Education	Sandra Kinney
Hawaii	Foundation for Independent Colleges, Inc.	Patricia DeWitt
	University of Hawaii	Sharyn Nakamoto
		Judy Shishido
Idaho	State Board of Education	Mitzi Matts Nancy C. Szofran
Illinois	Board of Higher Education	Carol K. Yoakum
	Community College Board	Pamela M. Lowrey
Indiana	Commission for Higher Education	Jennifer Seabaugh
Iowa	Independent Colleges of Indiana	Patrick Alles
	Board of Regents, State of Iowa	Diana Gonzalez
Kansas	College Student Aid Commission	Keith Greiner
	Board of Regents	Kurt Gunnell Dawn Ressel
Kentucky	Council on Postsecondary Education	Sherri Noxel
	Kentucky Community & Technical College System	Christina Whitfield
Louisiana	Board of Regents	Theresa R. Hay
		Kimberly Kirkpatrick
Maine	University of Maine System	Peter Small
Maryland	Higher Education Commission	Charles N. Benil Michael J. Keller
Massachusetts	Board of Higher Education	Jonathan E. Keller
Minnesota	Higher Education Services Office	Alexandra Djurovich
	Minnesota Private College Council	Douglas Shapiro
	State Colleges & Universities System	Craig Schoenecker
Mississippi	Institutions of Higher Learning	Christian Pruett
	State Board for Community & Junior Colleges	Beverlin Givens
Missouri	Department of Higher Education	Teala Sipes
		John Wittstruck

List of Participants by State

STATE	ORGANIZATION	NAME
Montana	University System	Laurie Neils Kevin Turner
Nebraska	Coordinating Commission for Postsecondary Education	Barbara McCuen Timothy J. Weis
Nevada	University & Community College System of Nevada	Patricia Casagrande Sally Jackson
New Hampshire	Postsecondary Education Commission University System of New Hampshire	Kathryn G. Dodge Judith A. Knapp Paula R. Hollis
New Jersey	Commission on Higher Education	Sathasivam Krishnan
New Mexico	Commission on Higher Education	Paul W. Landrum
New York	State Education Department State University of New York System Administration	Margaret Watrous John D. Porter
North Carolina	Community College System University of North Carolina-Office of the President	J. Keith Brown Billy Helton Robyn R. Render
North Dakota	University System	Julie Schepp Gina Padilla
Ohio	Board of Regents Independent Colleges & Universities Labor Market Information Bureau, Department of Job & Family Services	Harold Horton Robert P. Burke Mark J. Schaff Nancy K. Scott
Oklahoma	State Regents for Higher Education	James Purcell Laura Tyree
Oregon	Student Assistance Commission University System	Susan Degen Thomas M. North George Pernsteiner
Pennsylvania	Department of Education State System of Higher Education	Barbara T. Kern Jeff Kinsey Melinda Tobin
Puerto Rico	Council on Higher Education	Elmer E. Colon-Rivera Gloria Davila-Casasnovas
South Carolina	Commission on Higher Education Technical College System	Camille T. Brown Lynn W. Metcalf Robert Strickland
South Dakota	Board of Regents	Janelle Toman
Tennessee	Board of Regents Higher Education Commission	George Malo Chris Brewer
Texas	Higher Education Coordinating Board	Kathy Benson Susan Brown Kenneth Dalley David W. Gardner Jeffrey Phelps
Utah	Higher Education Coordinating Board Consultant System of Higher Education	Debbie Brennan Farah Thompson
Vermont	Norwich University State Colleges University of Vermont	Robert E. Schmidt Hope Swanson Fred A. Curran
Virginia	State Council of Higher Education for Virginia	Tod R. Massa
Washington	Association of Independent Colleges of Washington Higher Education Coordinating Board State Board for Community & Technical Colleges	Violet A. Boyer Patricia Mosqueda Michael D. Scroggins

List of Participants by State including National & Regional

STATE	ORGANIZATION	NAME
West Virginia	Higher Education Policy Commission	Jim Barton J. Michael Mullen Jeannie Reed
Wisconsin	Association of Independent Colleges & Universities University of Wisconsin System	Mari W. McCarty Sue Ellen Michalek
Wyoming	Community College Commission University of Wyoming	Andrea Bryant Constance S. Brizuela

National/Regional Participants and Other Speakers

ORGANIZATION	NAME
American Association of Collegiate Registrars & Admission Officers	Barbara Lauren
American Association of State Colleges & Universities	Travis Reindl
American Council on Education	Melanie E. Corrigan
Association for Institutional Research	Edward L. Delaney Terrence Russell
HigherEd.org, Inc.	John H. Milam
IT Innovative Solutions	Mohamad Sakr
National Association of College & University Business Officers	Jessica Shedd
National Association of Independent Colleges & Universities	Elise S. Miller
National Center for Education Statistics	Samuel Barbett Patricia Q. Brown Susan G. Broyles Dennis Carroll Andrew Mary Janice A. Plotczyk Sabrina Ratchford Cathy Statham
National Center for Higher Education Management Systems	John G. Clark Linda K. Keep Patrick J. Kelly
RTI International	Matthew Greene Jamie Isaac Janice Ennis Kelly-Reid
Southern Regional Education Board	Joseph L. Marks
State Higher Education Executive Officers	Tara Bisel Paul E. Lingenfelter Hans P. L'Orange Dianne K. Peterson Susan B. Winter David L. Wright
Vanderbilt University	James C. Hearn
Western Interstate Commission for Higher Education	Cheryl Blanco Brian Prescott

Hotel Floorplan

2nd Floor

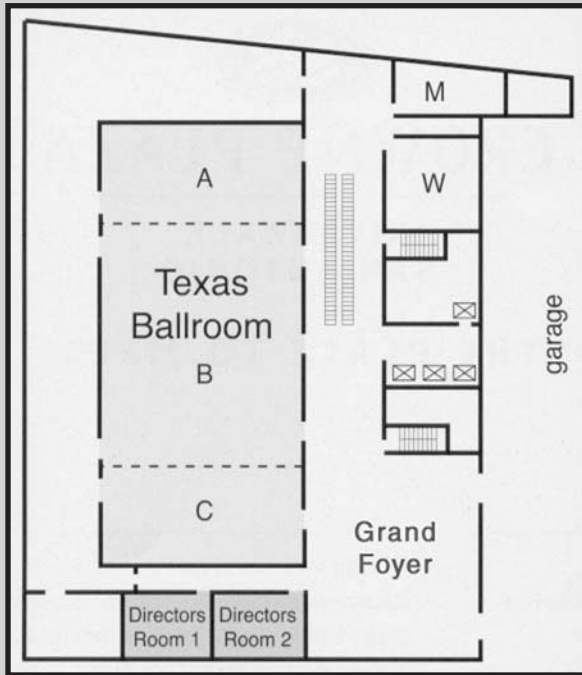

3rd Floor

